

ACCES BLOC

Stingator de incendiu  
portabil - P6 - clasa A

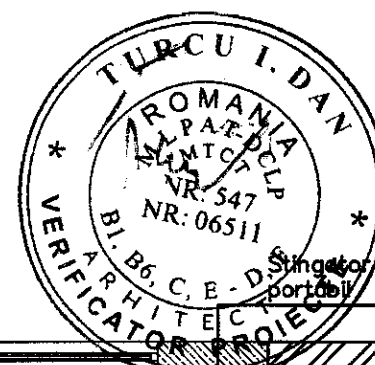

25. FEB. 2020

Stingator de incendiu  
portabil - P6 - clasa A

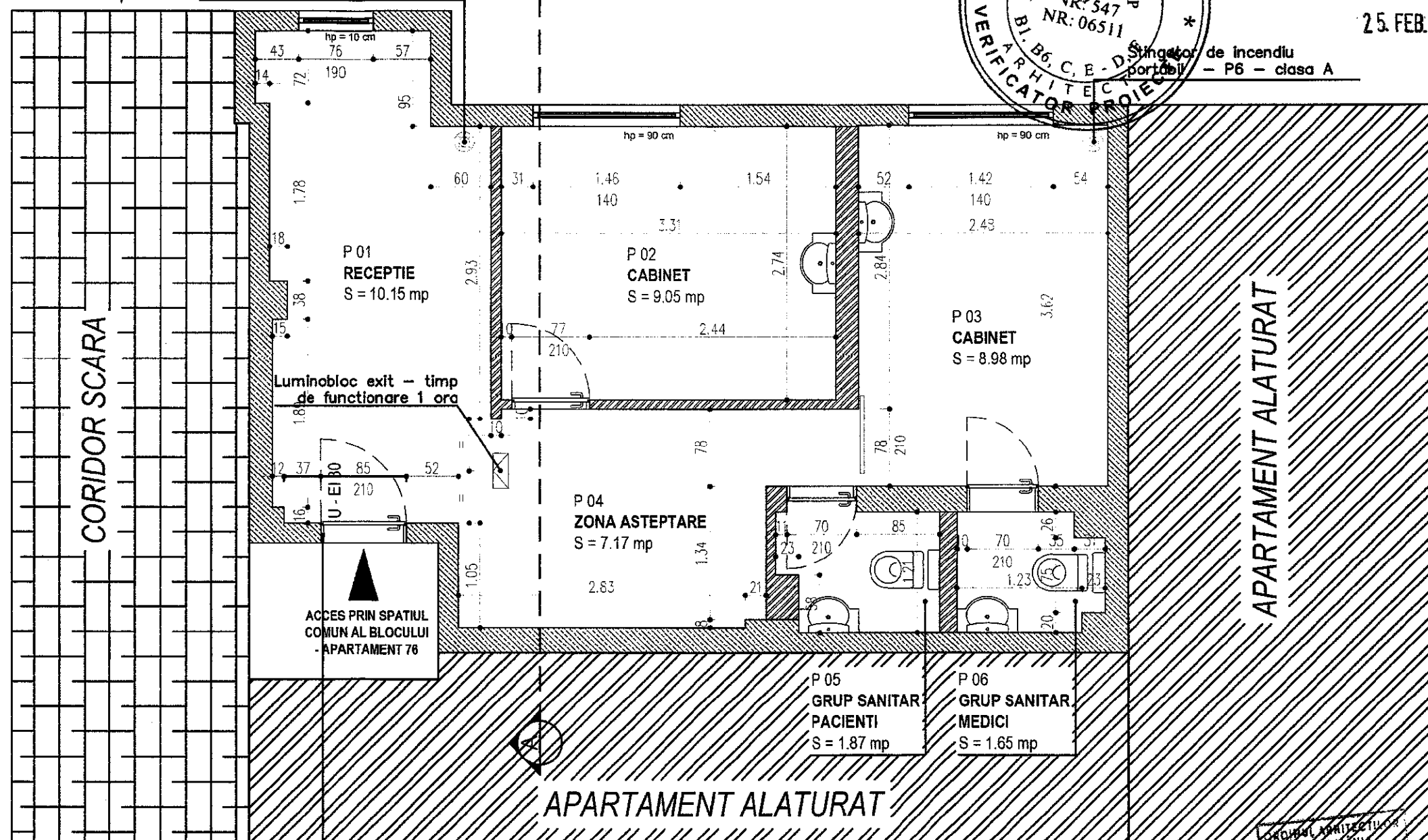
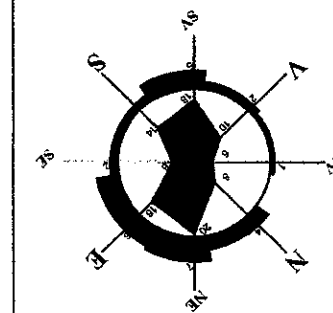

ACCES PRIN SPATIUL  
COMUN AL BLOCULUI  
- APARTAMENT 76

USA METALICA,  
INCOMBUSTIBILA

APARTAMENT ALATURAT

APARTAMENT ALATURAT

PLAN PROPUȘ - sc. 1:50

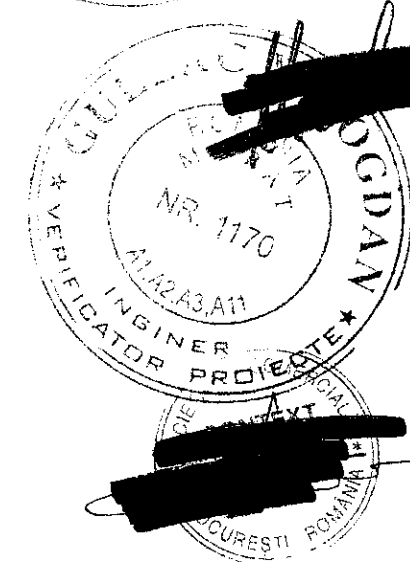
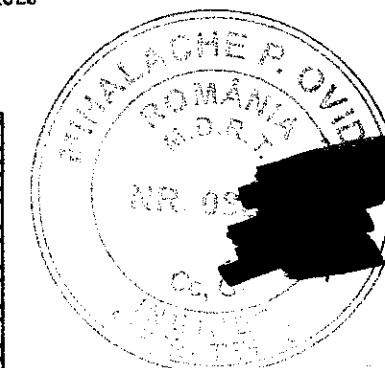
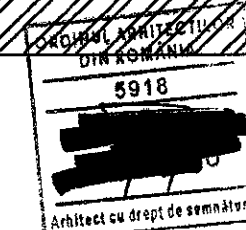

/// ZIDARIE CARAMIDA PT. EXTERIOR  
/// TERMOSISTEM CU POLISTIREN - 100 mm  
/// PERETI DE COMPARTIMENTARE - GIPS CARTON

CATEGORIA DE IMPORTANTA - C -  
(conform HGR 766/1997)  
CLASA DE IMPORTANTA - III -  
(conform normativ P100)  
GRAD II REZISTENTA LA FOC  
(conform normativ P118)  
N = 4 persoane  
Risc mic de incendiu

VERIFICATOR/ EXPERT	NUME	SEMNTURA	CERINTA	REFERAT / EXPERTIZA NR. / DATA	
SC CONTEXT PROIECT DESIGN SRL J40/ 5260 /2018; CUI 39199511 BUCURESTI				BENEFICIAR: BARBU GABRIELA	PROIECT NR. 33/2019
				AMPLASAMENT: Bd-ul Ion Mihalache, nr.142, Bl.BC. Sc.D, ap.76, sector 1, mun. Bucuresti	FAZA D.T.A.C.
SPECIFICATIE	NUME	SEMNTURA	SCARA:	TITLU PROIECT: Reamenajare, recompartimentare si schimbarea functiunii Ap.76, din locuinta in cabinet medical si birou	PLANSA NR. 01
VERIFICAT	Arh. Cosocariu Roxana		1:50		
PROIECTAT	Arh. Cosocariu Roxana		DATA	NUME PLANSA:	
DESENAT	Arh. Cosocariu Roxana		NOI 2019	PLAN PROPUȘ	